

**FLOOR PLAN**  
**OLYMPIAN CITY 2**  
**G/F, CENTRAL ATRIUM**

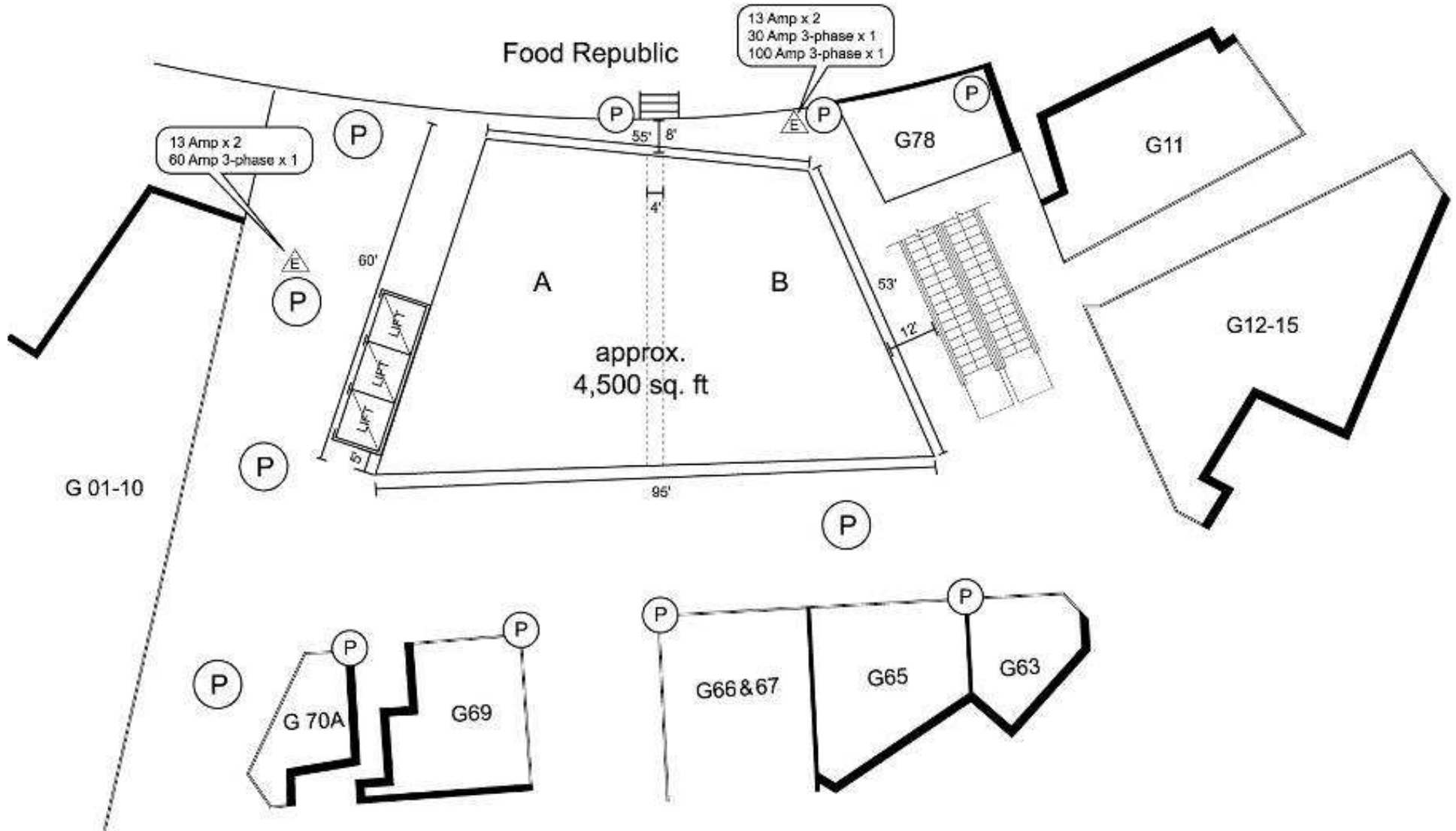

FLOOR PLAN  
OLYMPIAN CITY 2  
G/F, NORTH ATRIUM

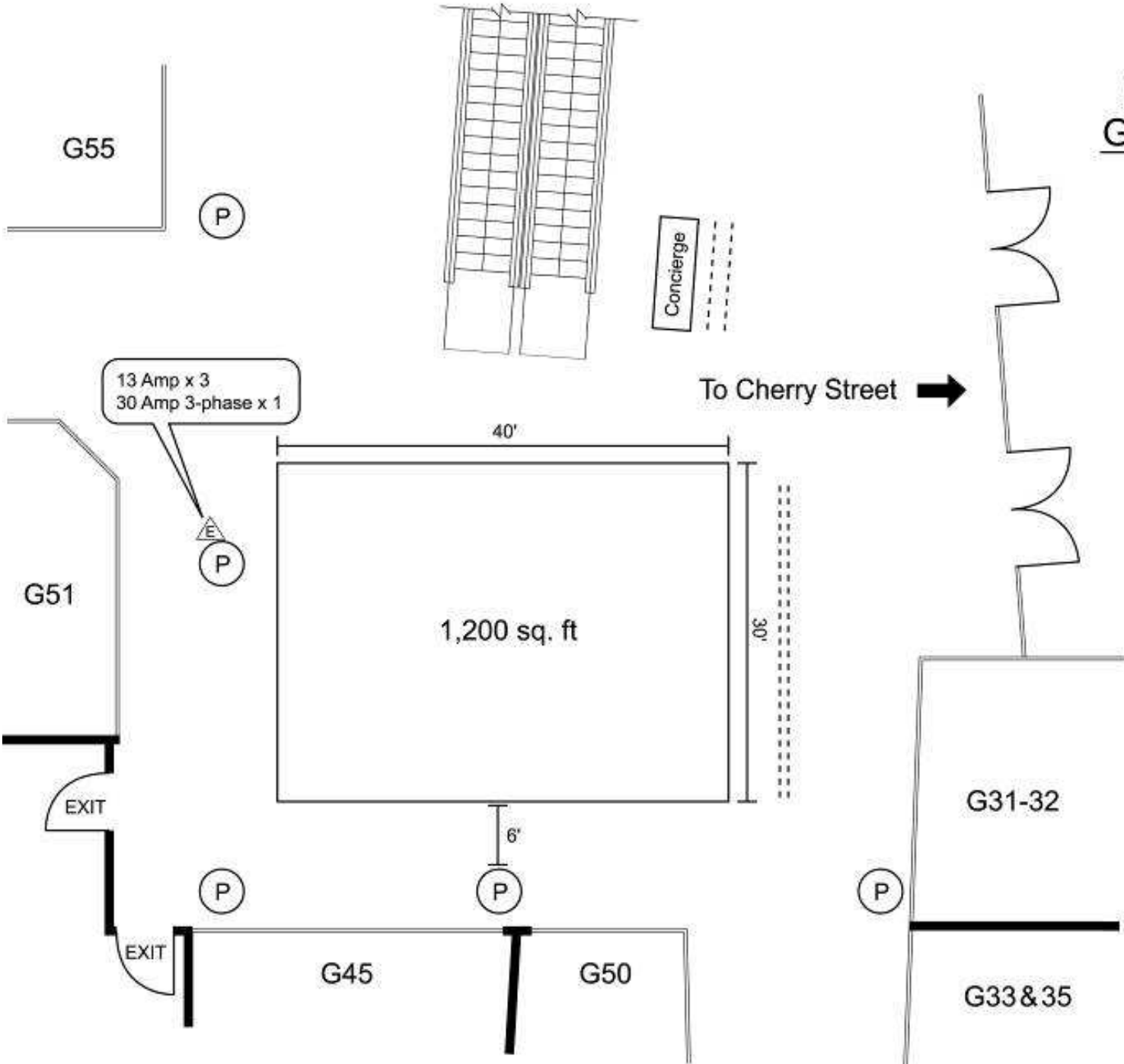

**FLOOR PLAN**  
**OLYMPIAN CITY 2**  
**G/F, PALM ALLEY 1,2&3**

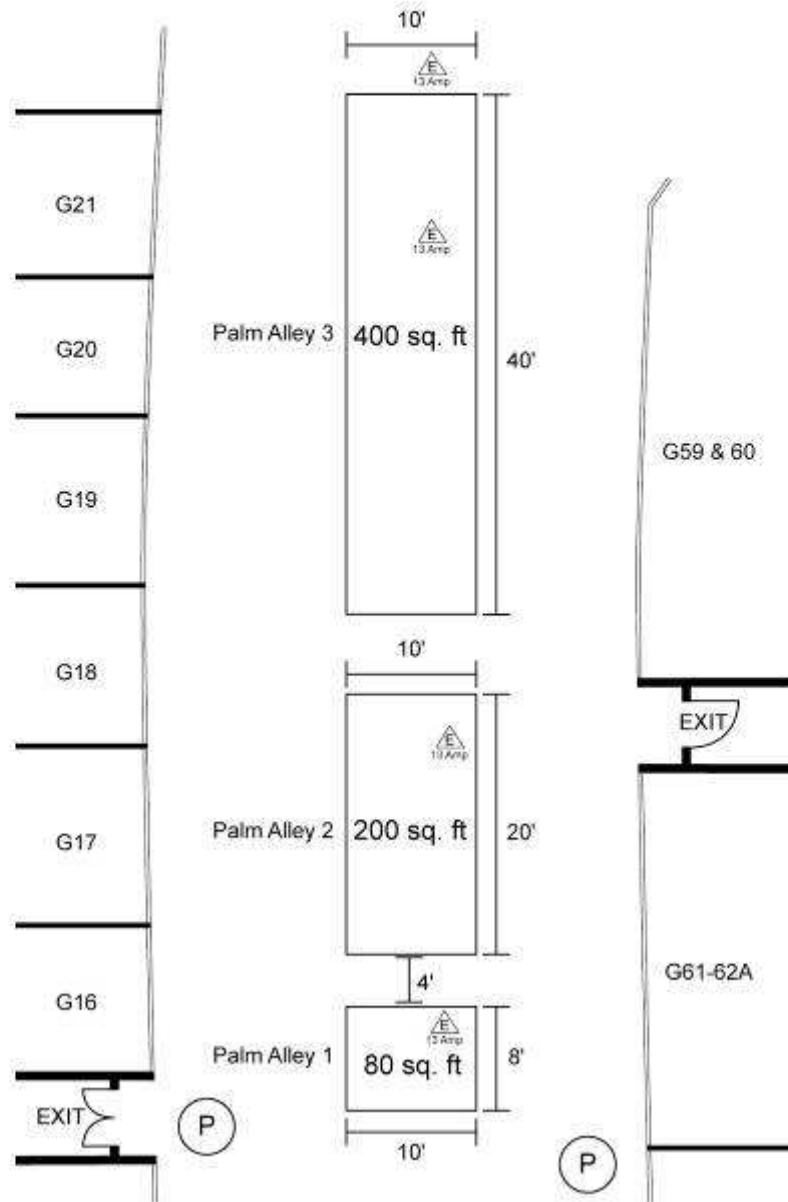

**FLOOR PLAN**  
**OLYMPIAN CITY 2**  
**G/F, PALM ALLEY 1,2&3**

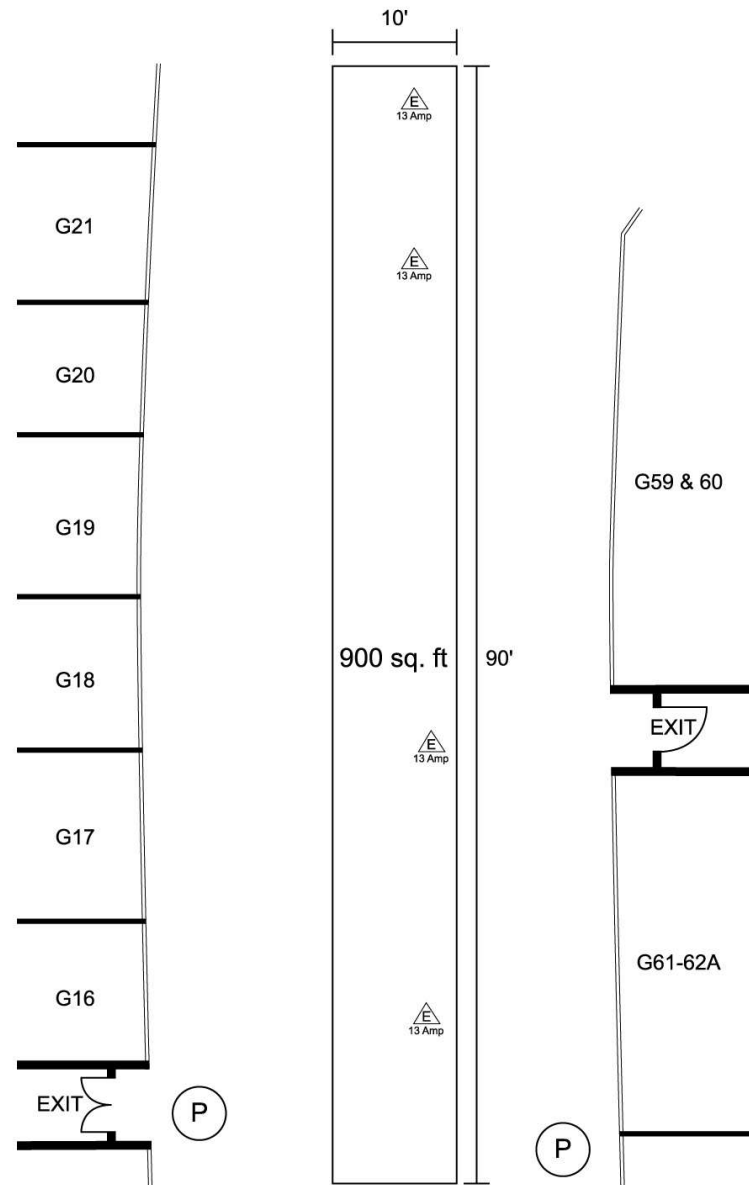

PalmAlley 1,2&3

FLOOR PLAN  
OLYMPIAN CITY 2  
G/F, PALM ALLEY 4

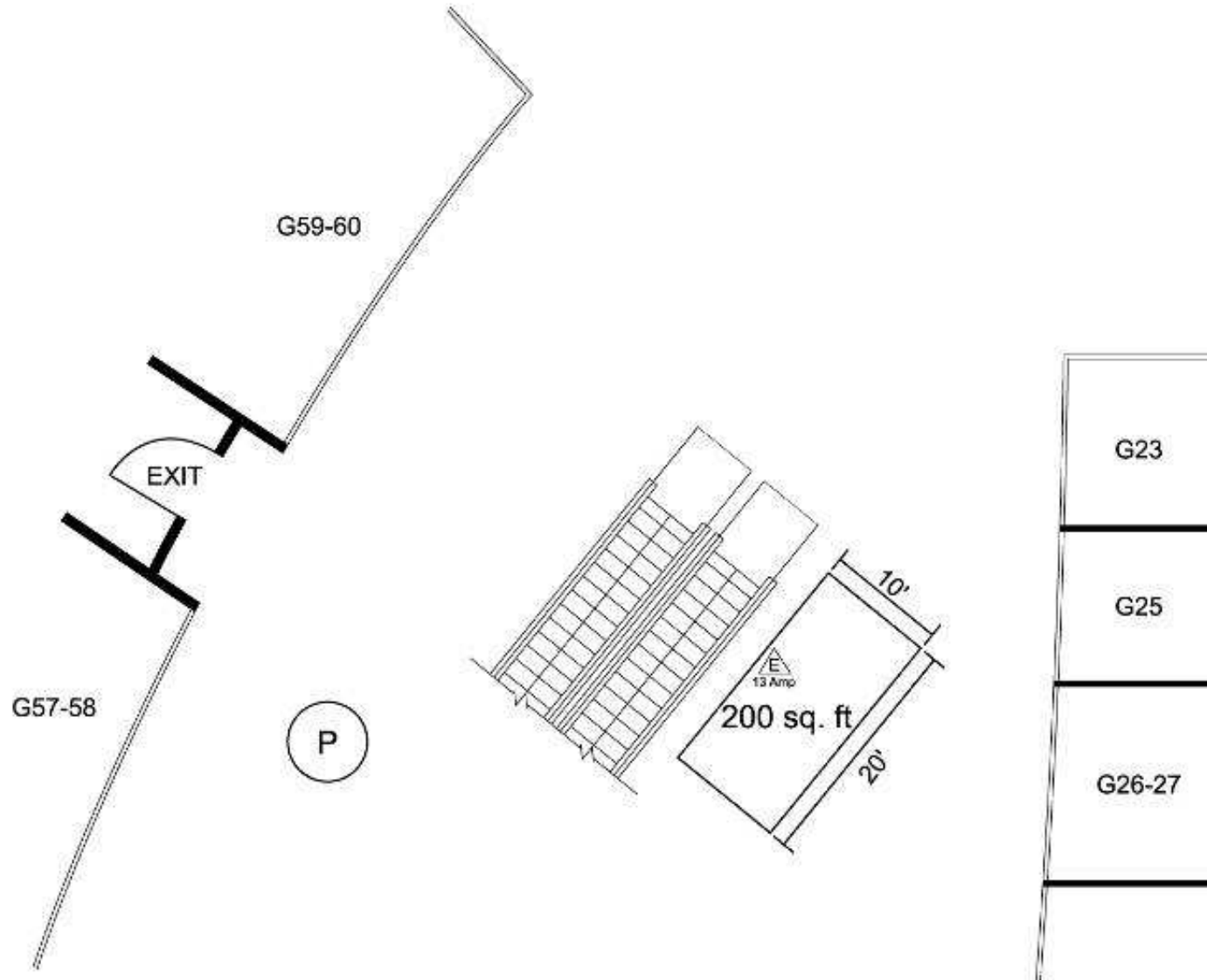

FLOOR PLAN  
OLYMPIAN CITY 2  
G/F, TV DEN



(P)

(P)

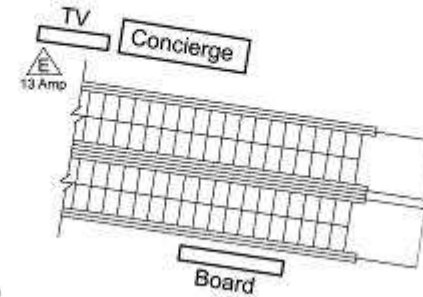
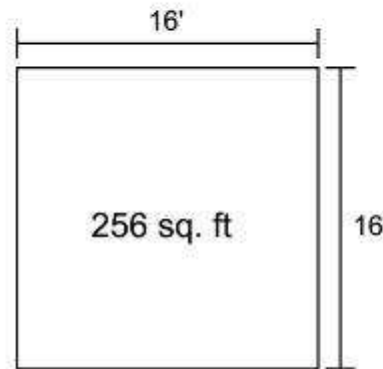
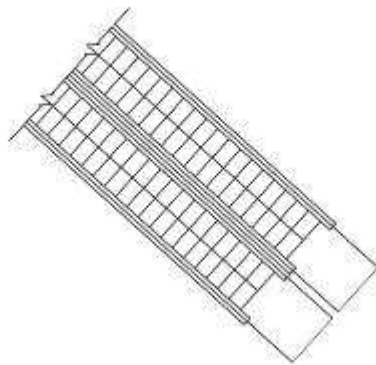

(P)

(P)

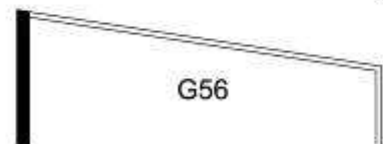

G57 & 58

G56